



fehn ship
management

MV "Fehn Courage"



Fehn Ship Management GmbH & Co. KG
Hafenstraße 15
26789 Leer – Germany

Phone + 49 (0) 491 928 15 – 5
Fax + 49 (0) 491 928 15 – 99
info@fehnship.de
[http:// www.fehnship.de](http://www.fehnship.de)

MV "Fehn Courage"

General

Type	General cargo ship, heavy cargo, Singledecker
Built	2010, Wuxue Kaiyanxing Shipbuilding, China, yard no. KYX07-801
Class	GL + 100 A5 Multi-Purpose Dry Cargo Ship Strengthened for heavy cargo + MC AUT CM-PS
IMO no.	9556818
Flag	Latvia
Port of registry	Riga
Call sign	YLLL

Dimensions

Length o.a.	87.91 m
Breadth	11.41 m
Draught	4.10 m
Air draft (in ballast)	abt. 21,5 m with mast up abt. 11,5 m with mast down
Gross tonnage / Net tonnage	1905 / 878
DWAT	abt. 2600 t

Machinery/ Speed

Main engine	ABC – Diesel, Type 6M DZC 1325 kW at 1000 rpm	
Generator	Auxiliary Engine	2x MAN 2866 - 160 kW
	Emergency Engine	1x MAN 2866 - 90 kW
Fuel specification	MGO	
Bow thrusters	Yes	
Speed	abt. 10,0 kn	
Capacity of tanks	Ballast water	1616,8 cbm
	MGO	131,9 cbm
	Fresh Water	43,0 cbm

MV "Fehn Courage"

Hold/ Hatches

One hatch	61,60 m x 9,00 m
One hold (incl. bulkheads)	61,60 m x 9,00 m x 6,16 m
Strength on main deck	1,5 t / sqm
Strength on tank top	15,0 t / sqm
Container capacity	n/a
Reefer plugs	n/a
Hatch cover type	Pontoon type
Grain with bulkhead in stow.pos.	abt. 120.600 cbf

Cargo features

Hold ventilation	Yes, 6 air circulations per hour (empty hold)
Dangerous goods	Yes – according certificates

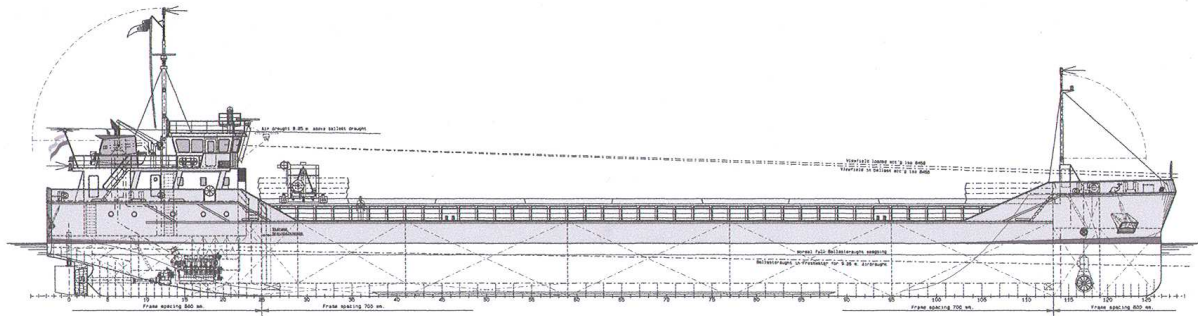

Details about, given in good all faith but not guaranteed. Particulars believed to be correct, but without guarantee.